



# AL WAIZ TOWER

COMMERCIAL  
PAYMENT PLAN

[WWW.ALWAIZGROUP.COM](http://WWW.ALWAIZGROUP.COM)



Gross Area: **200 SQ.FT**  
Shop Price: **Rs 10,000,000**

15% Down Payment: **1,500,000**  
15% After 1 Month: **1,500,000**  
40 Month Installment: **72,500**  
Baloon Payment: **300,000**  
Gray Structure 10% : **1,000,000**  
Last Installment 10%: **1,000,000**

Gross Area: **210 SQ.FT**  
Shop Price: **Rs 10,500,000**

15% Down Payment: **1,575,000**  
15% After 1 Month: **1,575,000**  
40 Month Installment: **78,750**  
Baloon Payment: **300,000**  
Gray Structure 10% : **1,050,000**  
Last Installment 10%: **1,050,000**

Gross Area: **225 SQ.FT**  
Shop Price: **Rs 11,250,000**

15% Down Payment: **1,687,500**  
15% After 1 Month: **1,687,500**  
40 Month Installment: **88,125**  
Baloon Payment: **300,000**  
Gray Structure 10% : **1,125,000**  
Last Installment 10%: **1,125,000**

Gross Area: **245 SQ.FT**  
Shop Price: **Rs 12,250,000**

15% Down Payment: **1,837,500**  
15% After 1 Month: **1,837,500**  
40 Month Installment: **100,625**  
Baloon Payment: **300,000**  
Gray Structure 10% : **1,225,000**  
Last Installment 10%: **1,225,000**

Gross Area: **250 SQ.FT**  
Shop Price: **Rs 12,500,000**

15% Down Payment: **1,875,000**  
15% After 1 Month: **1,875,000**  
40 Month Installment: **103,750**  
Baloon Payment: **300,000**  
Gray Structure 10% : **1,250,000**  
Last Installment 10%: **1,250,000**

Gross Area: **270 SQ.FT**  
Shop Price: **Rs 13,500,000**

15% Down Payment: **2,025,000**  
15% After 1 Month: **2,025,000**  
40 Month Installment: **116,250**  
Baloon Payment: **300,000**  
Gray Structure 10% : **1,250,000**  
Last Installment 10%: **1,250,000**

Gross Area: **300 SQ.FT**  
Shop Price: **Rs 15,000,000**

15% Down Payment: **2,250,000**  
15% After 1 Month: **2,250,000**  
40 Month Installment: **117,500**  
Baloon Payment: **400,000**  
Gray Structure 10% : **1,500,000**  
Last Installment 10%: **1,500,000**

Gross Area: **500 SQ.FT**  
Shop Price: **Rs 25,000,000**

15% Down Payment: **3,750,000**  
15% After 1 Month: **3,750,000**  
40 Month Installment: **190,000**  
Baloon Payment: **700,000**  
Gray Structure 10% : **1,250,000**  
Last Installment 10%: **1,250,000**

Gross Area: **515 SQ.FT**  
Shop Price: **Rs 25,750,000**

15% Down Payment: **3,862,500**  
15% After 1 Month: **3,862,500**  
40 Month Installment: **199,375**  
Baloon Payment: **700,000**  
Gray Structure 10% : **2,575,000**  
Last Installment 10%: **2,575,000**



# GROUND FLOOR

## OVERSEAS VISTA

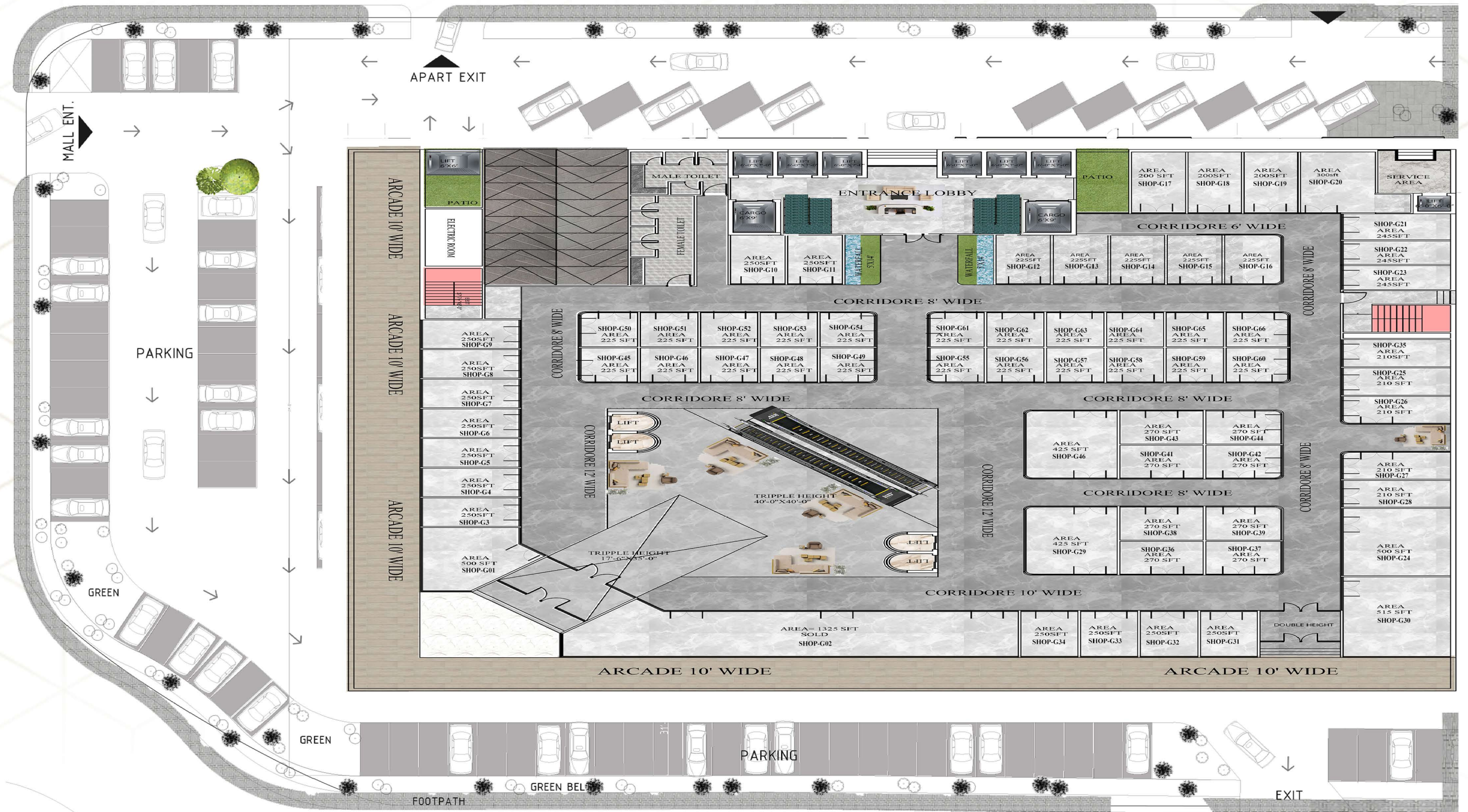



Gross Area: **175 SQ.FT**  
Shop Price: **Rs 6,125,000**

15% Down Payment: **918,750**  
15% After 1 Month: **918,750**  
40 Month Installment: **41,563**  
Baloon Payment: **200,000**  
Gray Structure 10% : **612,500**  
Last Installment 10%: **612,500**

Gross Area: **181 SQ.FT**  
Shop Price: **Rs 6,335,000**

15% Down Payment: **950,250**  
15% After 1 Month: **950,250**  
40 Month Installment: **35,438**  
Baloon Payment: **250,000**  
Gray Structure 10% : **633,500**  
Last Installment 10%: **633,500**

Gross Area: **200 SQ.FT**  
Shop Price: **Rs 7,000,000**

15% Down Payment: **1,050,000**  
15% After 1 Month: **1,050,000**  
40 Month Installment: **35,000**  
Baloon Payment: **300,000**  
Gray Structure 10% : **700,000**  
Last Installment 10%: **700,000**

Gross Area: **205 SQ.FT**  
Shop Price: **Rs 7,175,000**

15% Down Payment: **1,076,250**  
15% After 1 Month: **1,076,250**  
40 Month Installment: **37,188**  
Baloon Payment: **300,000**  
Gray Structure 10% : **717,500**  
Last Installment 10%: **717,500**

Gross Area: **215 SQ.FT**  
Shop Price: **Rs 7,525,000**

15% Down Payment: **1,128,750**  
15% After 1 Month: **1,128,750**  
40 Month Installment: **41,563**  
Baloon Payment: **300,000**  
Gray Structure 10% : **752,500**  
Last Installment 10%: **752,500**

Gross Area: **225 SQ.FT**  
Shop Price: **Rs 7,875,000**

15% Down Payment: **1,181,250**  
15% After 1 Month: **1,181,250**  
40 Month Installment: **45,938**  
Baloon Payment: **300,000**  
Gray Structure 10% : **787,500**  
Last Installment 10%: **787,500**

Gross Area: **230 SQ.FT**  
Shop Price: **Rs 8,050,000**

15% Down Payment: **1,207,500**  
15% After 1 Month: **1,207,500**  
40 Month Installment: **48,125**  
Baloon Payment: **300,000**  
Gray Structure 10% : **805,000**  
Last Installment 10%: **805,000**

Gross Area: **235 SQ.FT**  
Shop Price: **Rs 8,225,000**

15% Down Payment: **1,233,750**  
15% After 1 Month: **1,233,750**  
40 Month Installment: **50,313**  
Baloon Payment: **300,000**  
Gray Structure 10% : **822,500**  
Last Installment 10%: **822,500**

Gross Area: **270 SQ.FT**  
Shop Price: **Rs 9,450,000**

15% Down Payment: **1,417,500**  
15% After 1 Month: **1,417,500**  
40 Month Installment: **56,875**  
Baloon Payment: **350,000**  
Gray Structure 10% : **945,000**  
Last Installment 10%: **945,000**

Gross Area: **306 SQ.FT**  
Shop Price: **Rs 10,710,000**

15% Down Payment: **1,606,500**  
15% After 1 Month: **1,606,500**  
40 Month Installment: **63,875**  
Baloon Payment: **400,000**  
Gray Structure 10% : **1,071,000**  
Last Installment 10%: **1,071,000**

Gross Area: **341 SQ.FT**  
Shop Price: **Rs 11,935,000**

15% Down Payment: **1,790,250**  
15% After 1 Month: **1,790,250**  
40 Month Installment: **79,188**  
Baloon Payment: **400,000**  
Gray Structure 10% : **1,193,500**  
Last Installment 10%: **1,193,500**



# FIRST FLOOR

## INOVATION HUB

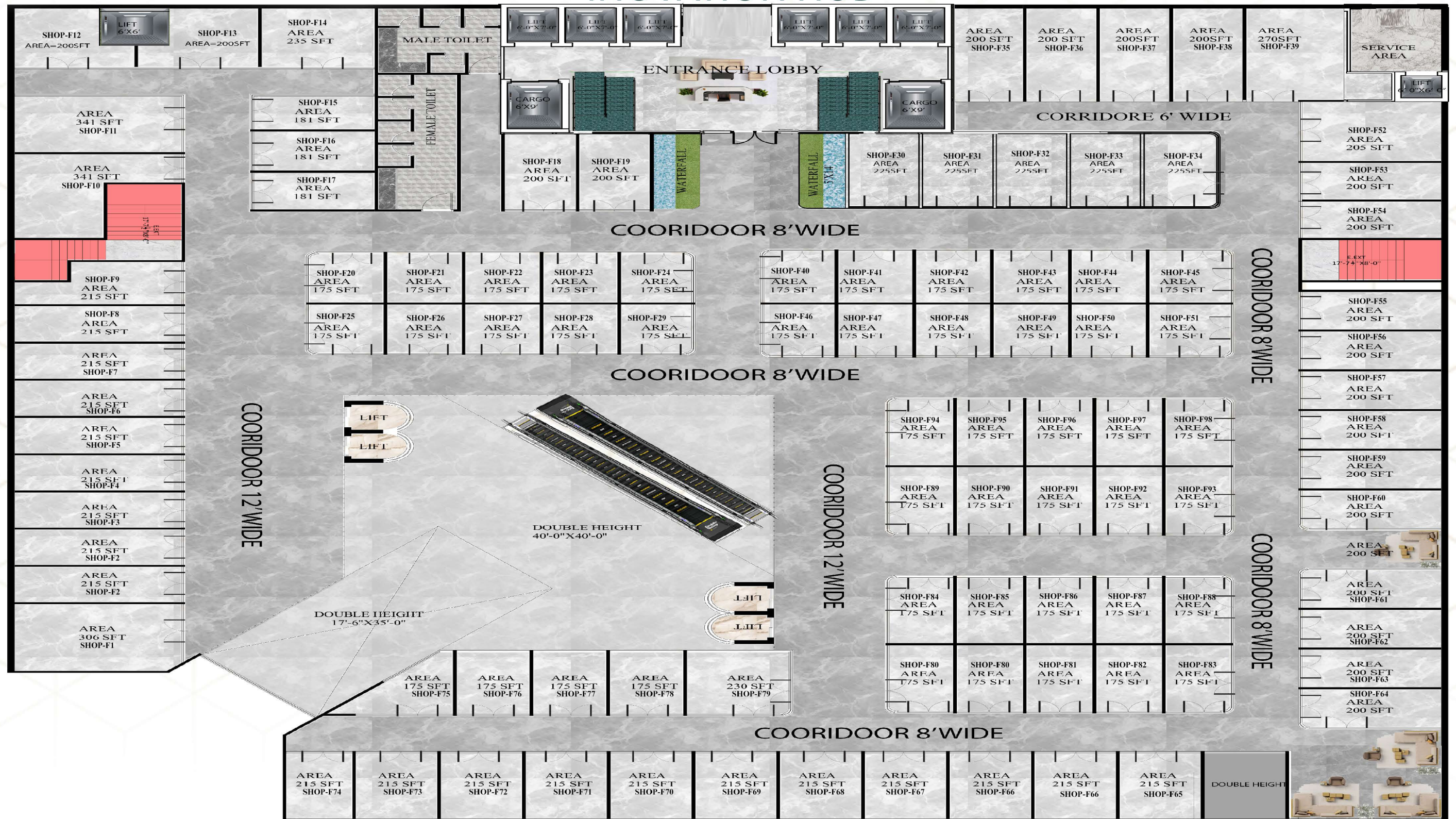





# AL-WAIZ DEVELOPERS

KEY TO YOUR SUCCESS

DIORTALKS  
the female gaze



AL-WAIZ  
TOWER



The Elegance  
Tower



[WWW.ALWAIZGROUP.COM](http://WWW.ALWAIZGROUP.COM)